

# GEL BATTERY 120Ah MAXX

12V Voltage  
120Ah Capacity



# MAXX

## TECHNICAL DATA

INDEX	B0012
MODEL	120Ah MAXX
Nominal voltage [V]	12
Nominal capacity [Ah]	120
Standard terminal	T2
Length [mm]	330
Width [mm]	171
Housing height [mm]	214
Overall height [mm]	220
Weight +/- 3% [kg]	30,8
Cyclic charging [V]	14,4-14,9
Buffer charge [V]	13,5-13,8
Self-discharge within 3 months	91%
Self-discharge within 6 months	82%
Self-discharge within 12 months	64%
Internal resistance [mΩ]	5

## BATTERY LIFE

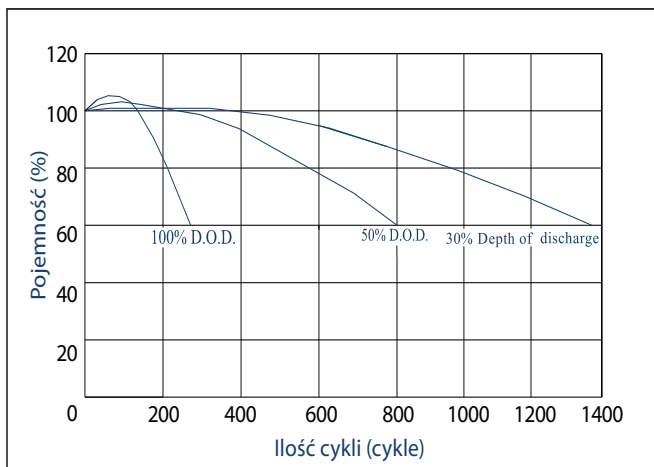

## DISCHARGE CHARACTERISTICS

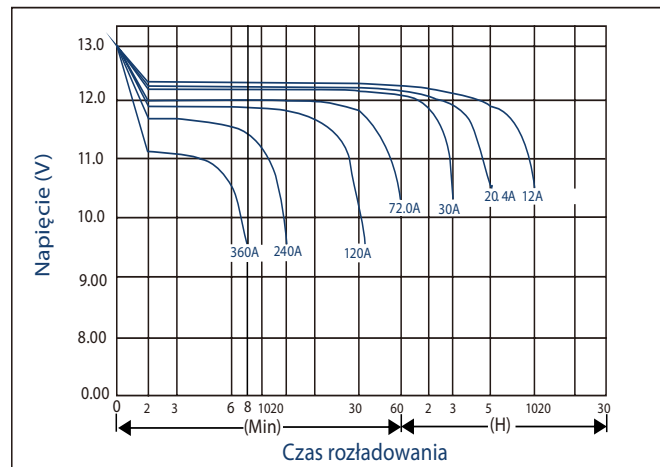

## TYPE OF TERMINAL

Standard terminal T2

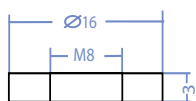

(in mm)

## TECHNICAL FIGURE (mm)

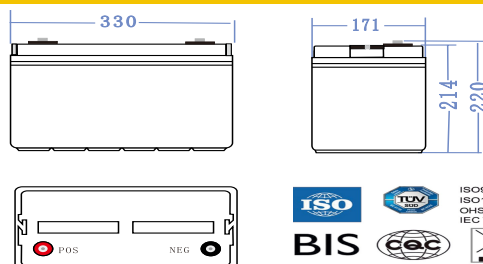

## CONSTANT-CURRENT (25°C) CONSTANT-POWER (AT 25°C) DISCHARGE TABLE

time		10min	15min	30min	1h	2h	3h	4h	5h	8h	10h	20h
9,60V	A	257	200	121,2	75,1	44,3	30,8	25,1	21,4	14,6	12,2	6,4
	W	2745	2190	1351	852	511	360	294	252	173	144,7	76,7
9,90V	A	250	196	118,8	74,0	44,0	30,7	25,0	21,2	14,6	12,2	6,4
	W	2678	2146	1329	842	508	359	294	251	173	145,2	76,6
10,20V	A	239	188	115,2	72,1	43,7	30,5	24,7	21,1	14,5	12,1	6,4
	W	2572	2074	1294	823	505	357	291	250	172	144,0	76,5
10,50V	A	229	182	112,4	70,7	43,1	30,2	24,6	21,0	14,4	12,1	6,3
	W	2475	2016	1267	809	500	354	290	249	171	144,0	76,1
10,80V	A	216	173	108,4	68,5	42,0	29,4	23,9	20,4	13,9	12,0	6,3
	W	2339	1916	1226	787	488	345	283	242	166	142,8	75,6

The electrical parameters indicated on the product label may differ slightly from the specifications.



4Sun sp. z o.o. sp.k.  
Annopol 4, 03-236 Warszawa  
tel: (22) 114 98 05, email: biuro@4sun.eu

www.4sun.eu